

## Exhaust air heat pump

### **NIBE F370**

**NIBE F370 is an all-in-one exhaust air heat pump which provides heating, ventilation, heat recovery and hot water efficiently, simply and economically. With its attractive, stylish design and compact size, the heat pump is easy to accommodate and**

**install.**

With its built-in water heater, immersion heater, circulation pump, fan and control system, the heat pump provides a reliable and economical source of heat. The heat pump can be connected to any low-temperature distribution system, e.g. radiators, convectors or underfloor heating. NIBE F370 can be connected to other heat sources, e.g. district heating.

Thanks to smart technology, the product gives you control over your energy consumption and will be a key part of your connected home. The efficient control system automatically adjusts the indoor climate for maximum comfort, and you do nature a favour at the same time.

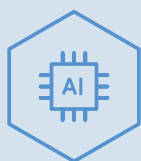

- **Heating, hot water, ventilation and heat recovery.**
- **Cost-effective residential heating for new dwellings but also for renovation and replacement market.**
- **Connected home with smart technology for a simpler life.**

# This is how F370 works

## Principle

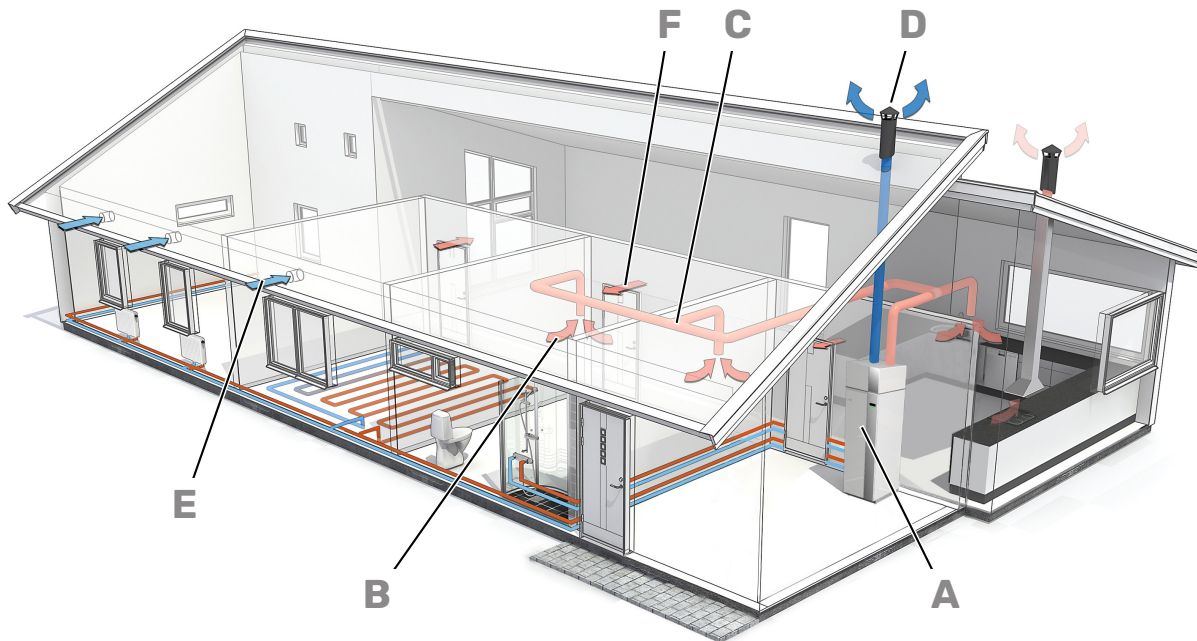

F370 is an exhaust air heat pump with integrated fan and a water heater that is provided with corrosion protection in the form of copper, enamel or stainless steel. In addition, it has an integrated immersion heater.

Energy is recovered from the ventilation air and supplied to the heat pump, which reduces energy costs considerably. The device ventilates the house, supplies heat and produces domestic hot water. F370 is intended for low-temperature dimensioned radiator circuits and/or underfloor heating.

F370 is intended for both new installations and replacement in houses or similar.

Using accessories, F370 can be docked with other heat sources.

- A** F370 supplies the house with both hot water and room heating.
- B** The warm room air is drawn into the air duct system.
- C** The warm room air is fed to F370.
- D** The room air is released when it has passed F370. The air temperature has then been reduced as F370 has extracted the energy in the room air.
- E** Outdoor air is drawn into the house.
- F** Air is transported from rooms with outdoor air devices to rooms with exhaust air valves.

## Design

Control of F370 is designed to ensure easy operation while always enabling the heat pump to run as efficiently as possible. F370 decides on the best operation mode and is able to control several climate systems when several different supply temperatures are required. The display shows the current temperatures and set values in plain text.

The design of the ventilation section gives a high ventilation capacity. The steplessly adjustable fan can easily be increased or reduced via the display unit or an external signal.

F370 gives great savings thanks to an efficient compressor, which, by means of intelligent control, works with the most favourable temperature conditions at the time.

The outer casing is of white powder-coated steel plate. The front door is easy to remove for easy access when installing and for servicing.

F370 has a maximum immersion heater output of 10.3 kW. The power is easy to adjust via the display, and the heat pump can be blocked.

## Principle of operation, cooling circuit

When the exhaust air at room temperature passes through the evaporator, the refrigerant evaporates because of its low boiling point. In this way the energy in the room air is transferred to the refrigerant.

The refrigerant is then compressed in a compressor, causing the temperature to rise considerably.

The warm refrigerant is led to the condenser. Here the refrigerant gives off its energy to the heating system water, whereupon the refrigerant changes state from gas to liquid.

The refrigerant then goes via filters to the expansion valve, where the pressure and temperature are reduced.

The refrigerant has now completed its circulation and returns to the evaporator.

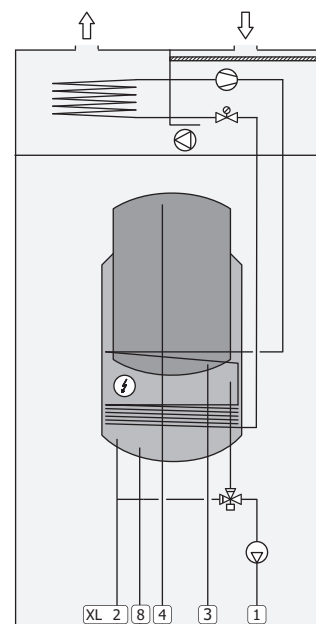

XL1	Connection, heating medium flow
XL2	Connection, heating medium return
XL3	Cold water connection
XL4	Hot water connection
XL8	Docking connection, supply

# Good to know about F370

## Transport and storage

F370 should be transported and stored vertically in a dry place.

Ensure that the heat pump cannot fall over during transport.

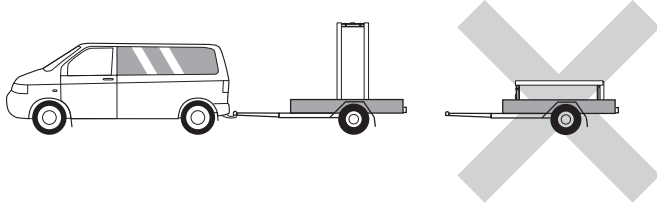

However, the F370 can be carefully laid on its back when being moved into the building. The centre of gravity is in the upper part.

## Supplied components

Local differences in the enclosed kit may occur. See relevant installer manual for more information.

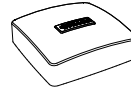

Outdoor temperature sensor



Room sensor



Earth cabling (2 pcs)



Current sensor

## LOCATION

The kit of supplied items is placed on top of the product.

## Installation and positioning

- Place F370 on a solid foundation indoors that can take the heat pump's weight.
- Because water comes from F370, the floor coating is important. A waterproof floor or floor membrane is recommended.
- Because water comes from F370, it is good if the area where the heating pump is located is provided with floor drainage.
- Install with its back to an outside wall, ideally in a room where noise does not matter, in order to eliminate noise problems. If this is not possible, avoid placing it against a wall behind a bedroom or other room where noise may be a problem.
- Wherever the unit is located, walls to sound sensitive rooms should be fitted with sound insulation.
- Route pipes so they are not fixed to an internal wall that backs on to a bedroom or living room.
- The heat pump's installation area should always have a temperature of at least 10 °C and max 30 °C.

## INSTALLATION AREA

Leave a free space of 800 mm in front of the product. Leave free space between F370 and wall/other machinery/fittings/cables/pipes etc. It is recommended that a space of at least 10 mm is left to reduce the risk of noise and of any vibrations being propagated.

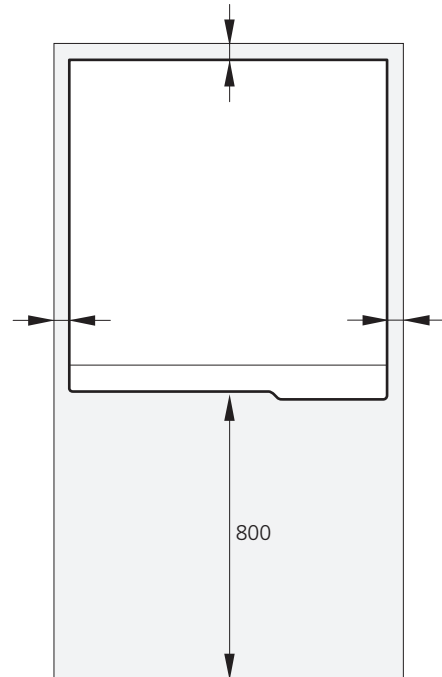

Ensure that there is sufficient space (300 mm) above F370 for connecting ventilation ducts.

# Installation

## Equipment

F370 is equipped with a climate-controlled heating control system with outdoor temperature, room temperature and supply temperature sensors, circulation pump, load monitor and expansion vessel. For the heating section, F370, copper and stainless steel, is equipped with a filling and a safety valve. The hot water section in F370 copper and stainless steel is equipped with a set of valves comprising filling, mixing, non-return and safety valves.

## Maximum boiler and radiator volumes

F370 is equipped with an expansion vessel.

The volume of the expansion vessel is 10 litres and it is pre-pressurised as standard to 0.5 bar. As a result, the maximum permitted height between the expansion vessel and the highest radiator is 5 metres. There is a valve on the expansion vessel for any pre-pressure adjustment.

The maximum system volume, excluding F370, is 219 litres at the above-mentioned pre-pressure.

## Inspection

F370 is equipped with a closed expansion vessel as standard. National standards can assert that the boiler installation must be inspected before it is taken into use. This inspection may only be performed by persons with the necessary expertise.

National regulations can assert that the function of the ventilation system must be checked. This check may only be carried out by an authorised person.

## Pipe installation



Pipe installation must be carried out in accordance with current norms and directives.

Pipe connections for cold and hot water as well as supply and return lines are fitted with 22 mm compression ring couplings.

### CONNECTING THE HEATING SYSTEM

When the circulation pump is operating, the flow in the heating system must not be stopped completely, i.e. at least one of the heating system's radiators/underfloor heating coils must be fully open. For F370 enamel, the heating system must be supplemented with a safety valve according to applicable standards.

### AVAILABLE EXTERNAL PRESSURE, HEATING SYSTEM

#### Capacity, circulation pump (CP)

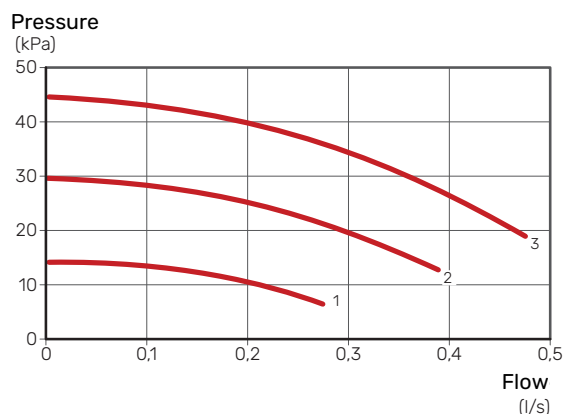

## Installation alternative



### **TAP WATER CONNECTION**

The system should be supplemented with an extra water heater, if a large bath tub or other significant consumer of hot water is installed. For F370 enamel, the domestic water system must be supplemented with a safety valve and necessary valve equipment according to applicable standards.

### **WATER HEATER WITH IMMERSION HEATER**

In a water heater with an immersion heater, the water is initially heated by the heat pump. The immersion heater in the water heater is used for keeping warm and when the heat pump does not have sufficient power.

The water heater's flow is connected after F370.



## Ventilation



Connect F370 so that all the exhaust air, except kitchen duct air (kitchen fan), passes through the evaporator in the heat pump.

- The ventilation flow must comply with the applicable national standards.
- For optimum heat pump performance, the ventilation flow must not be less than 28 l/s (100 m<sup>3</sup>/h) at an exhaust air temperature of at least 20°C. When the exhaust air temperature is lower than 20°C (for example at start-up and when there is nobody at home), the minimum value is 31 l/s (110 m<sup>3</sup>/h).
- The heat pump's installation area must be ventilated to at least 5 l/s (18 m<sup>3</sup>/h)
- If the exhaust air temperature falls below 16 °C, the compressor is blocked and electric additional heat is permitted. No energy is recovered from the exhaust air when the compressor is blocked.
- Connections must be made via flexible hoses, which should be installed so that they are easy to replace.
- Provision must be made for inspection and cleaning of the duct.
- The air duct system must be a minimum of air tightness class B.
- To prevent fan noise being transferred to the ventilation devices, install silencers in suitable locations in the duct system.
- Because the extract air temperature can be low, the extract air duct must be insulated with diffusion-proof material (at least PE30 or equivalent) along its entire length.
- Exhaust air ducts that are routed in cold areas must be insulated.
- All joins in the ducting must be sealed to prevent leakage.
- The extract air duct must be a maximum of 20 m long with a maximum of six bends.
- Because the heat pump contains a flammable refrigerant, the air ducting system must be earthed. This is done by making a good electrical connection to the air ducts using the enclosed earth cables (2).
- A duct in a masonry chimney stack must not be used for extract air.
- If a stove or similar is installed, it must have airtight doors. It must also be able to take combustion air from outside.
- Incorrect adjustment of the ventilation may lead to reduced installation efficiency and thus poorer operating economy, a poorer indoor climate and moisture damage in the building.

## SETTING THE FAN CAPACITY

Select the ventilation capacity steplessly in the display.

### Ventilation capacity

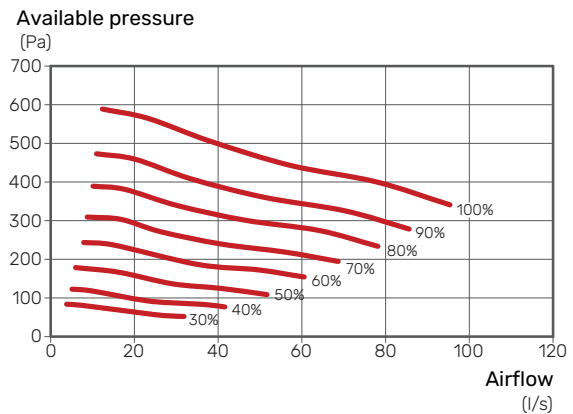

## VENTILATION CONNECTIONS

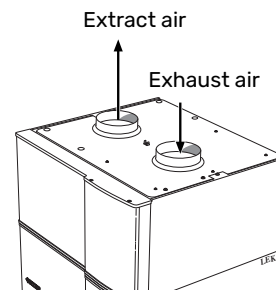



## Electrical connections



Connection must not be carried out without the permission of the electricity supplier and must be under the supervision of a qualified electrician.

F370 must be installed via an isolator switch. The cable area has to be dimensioned based on the fuse rating used.

F370 must be connected with the corresponding connection cable (length approx. 2 m).

The connection cable can be found on the reverse of F370 (see dimensions diagram below).

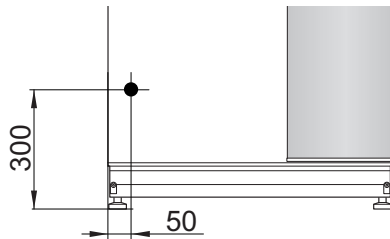

All electrical equipment, except the outdoor sensors, room sensors and the current sensors are ready connected at the factory.

Operation (230 V), fan, compressor, circulation pump, etc., are internally fused by a miniature circuit breaker.

### 3X400 V

Electrical addition (kW)	Max (A) L1	Max (A) L2	Max (A) L3
0.0	5.3	-	-
2.0	5.3	-	8.7
4.7	5.3	11.6	8.7
5.6 <sup>1</sup>	5.3	11.6	11.6
8.0	16.9	11.6	11.6
10.3	16.9	12.7	20.3

<sup>1</sup> Factory setting

The table displays the maximum phase current for the relevant power step for the heat pump.

### 3X230 V

Electrical addition (kW)	Max (A) L1	Max (A) L2	Max (A) L3
0.0	3.9	3.9	-
2.0	3.9	11.2	8.7
4.7	14.0	11.2	17.6
6.7 <sup>1</sup>	14.0	19.6	25.3
8.0	23.6	23.6	20.1
10.0	23.6	31.1	28.0

<sup>1</sup> Factory setting

The table displays the maximum phase current for the relevant power step for the heat pump.

### EXTERNAL CONTROL AND LOAD MONITOR.

In cases where an external control is required, it can be connected to a terminal block.

F370 is equipped with two types of integrated load monitors. The basic monitor calculates whether future immersion heater steps can be connected without the specified main fuse tripping. The more advance monitor is used together with the enclosed current sensors, which are installed in the electrical distribution unit and connected to a terminal block in F370.

If the current sensors are connected, F370 monitors the phase currents in the building and allocates the power steps automatically to the least loaded phase.

# Functions

## Control, general

The indoor temperature depends on several different factors. Sunlight and heat emissions from people and household machines are normally sufficient to keep the house warm during the warm seasons. When it gets colder outside, the climate system needs to help heat the house. The colder it is outside, the warmer radiators and underfloor heating systems have to be.

Control of the heat production is performed based on the "floating condensing" principle, which means that the temperature level needed for heating at a specific outdoor temperature is produced based on collected values from the outdoor and supply temperature sensors. The room sensor can also be used to compensate the deviation in room temperature.

## Heat production



The supply of heat to the house is regulated in accordance with the heating curve selected setting. After adjustment, the correct amount of heat for the current outdoor temperature is supplied.

### OWN CURVE

F370 has pre-programmed non-linear heating curves. It is also possible to create your own defined curve. This is an individual linear curve with a number of break points. You select break points and the associated temperatures.

## Hot water production



Hot water charging starts when the temperature has fallen to the set start temperature. Hot water charging stops when the hot water temperature at the hot water sensor has been reached.

For temporary higher hot water demand, there is a function that allows the temperature to be raised temporarily for up to 12 hours or by a one time increase (can be selected in the menu system).

It is also possible to set F370 in holiday mode, which means that the lowest possible temperature is achieved without the risk of freezing.

## Additional heat only



F370 can be used with only additional heat (electric boiler) to produce heating and hot water, for example, before the ventilation system is complete.

## Alarm indications



The status lamp lights red in the event of an alarm and the display shows detailed information depending on the fault. An alarm log is created with each alarm containing a number of temperatures, times and operating status.

## The display



F370 is controlled using a clear and easy to use display.

Instructions, settings and operational information are shown on the display. You can easily navigate between the different menus and options to set the comfort or obtain the information you require.

The display unit is equipped with a USB socket that can be used to update the software and save logged information in F370.

Visit [nibeuplink.com](http://nibeuplink.com) and click the "Software" tab to download the latest software for your installation.

## NIBE Uplink



Using the Internet and NIBE Uplink, you can obtain a quick overview and the present status of the installation and the heating in your home. You can obtain a good overall view, allowing you to monitor and control the heating and hot water comfort effectively. If the system is affected by a malfunction, you receive an alert via e-mail that allows you to react quickly.

NIBE Uplink also gives you the opportunity to control the comfort in your home easily, no matter where you are.

### RANGE OF SERVICES

You have access to different levels of service via NIBE Uplink. A basic level that is free and a premium level where you can select different extended service functions for a fixed annual subscription fee (the subscription fee varies depending on the selected functions).

NIBE Uplink also available as an app from App Store and Google Play.

### INSTALLATION AND ASSOCIATED EQUIPMENT REQUIREMENTS

NIBE Uplink needs the following in order to communicate with your F370:

- network cable
- Internet connection to which F370 can be connected
- web browser with JavaScript activated
- account on nibeuplink.com

We recommend our mobile app for NIBE Uplink.

If it is not possible to connect to NIBE Uplink, F370 can be controlled remotely via text message. For this, the SMS 40 accessory is required.

For more information, visit [nibeuplink.com](http://nibeuplink.com).

## NIBE SMART PRICE ADAPTION™



Smart Price Adaption is not available in all countries. Contact your NIBE dealer for more information.

Smart Price Adaption adjusts the system's consumption according to the time of day when electricity prices are lowest. This allows for savings, provided that an hourly rate subscription has been signed with the electricity supplier.

The function is based on hourly rates for the coming day being downloaded via NIBE Uplink. To use the function, an Internet connection and account on NIBE Uplink are necessary.

### SMART HOME

When you have a smart home system that can communicate with NIBE Uplink, you can control the installation via an app by activating the "smart home" function.

By allowing connected units to communicate with NIBE Uplink, your heating system becomes a natural part of your homesmart home and gives you the opportunity to optimise the operation.

Remember that the "smart home" function requires NIBE Uplink in order to work.

# Technical data

## Dimensions

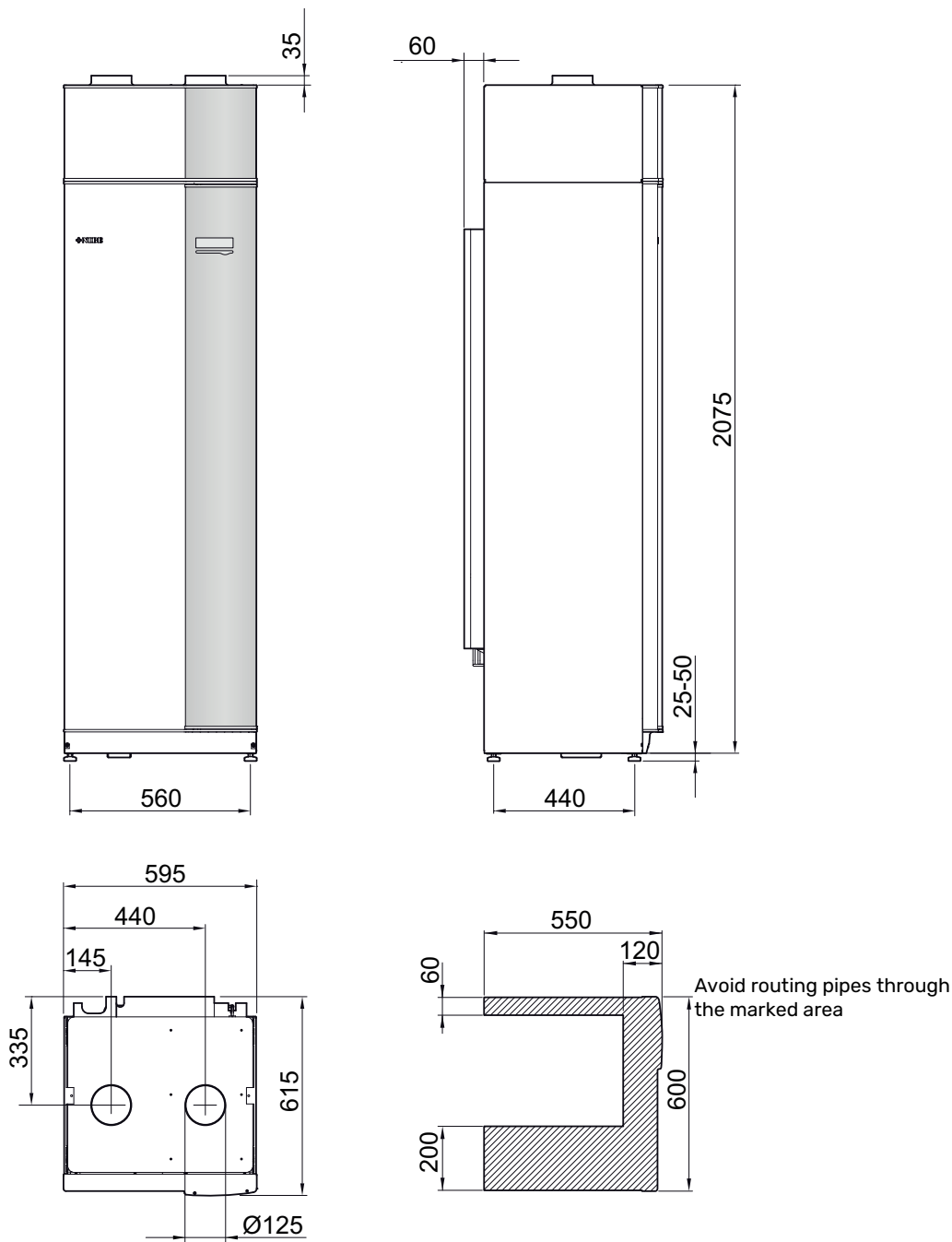

# Pipe connections

## STAINLESS

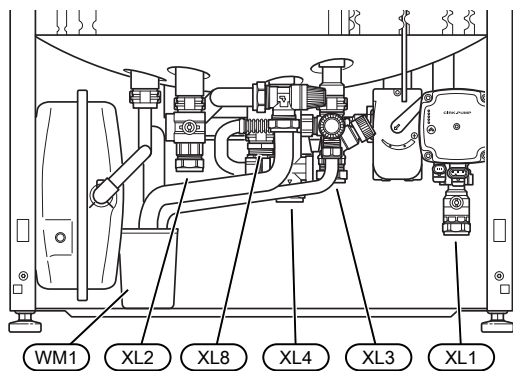

## ENAMEL

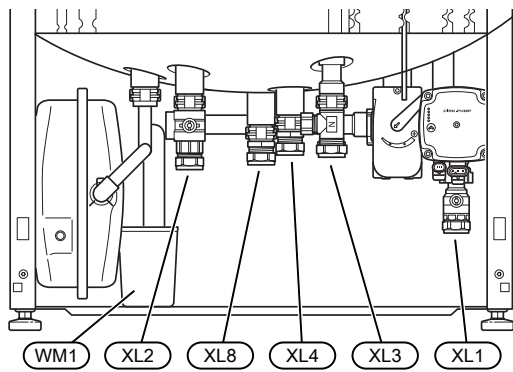

## SETTING OUT DIMENSIONS

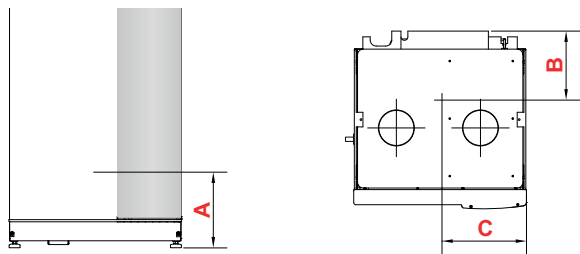

## Stainless

Connection		A	B	C
XL1 Heating medium supply	(mm)	135	360	65
XL2 Heating medium return	(mm)	215	425	385
XL3 Cold water	(mm)	200	455	215
XL4 Hot water	(mm)	180	405	265
XL8 Docking	(mm)	220	290	300
WM1 Overflow cup	(mm)	95	205	430

## Enamel

Connection		A	B	C
XL1 Heating medium supply	(mm)	135	360	65
XL2 Heating medium return	(mm)	215	425	385
XL3 Cold water	(mm)	230	455	215
XL4 Hot water	(mm)	235	405	265
XL8 Docking	(mm)	220	290	300
WM1 Overflow cup	(mm)	95	205	430

## PIPE DIMENSIONS

Connection		
XL1-XL2 Heating medium ext Ø	(mm)	22
XL3 Cold water ext Ø	(mm)	22
XL4 Hot water ext Ø	(mm)	22
XL8 Docking ext. Ø	(mm)	22
WM2 Overflow water discharge	(mm)	32

# Technical specifications

The following data only applies to F370 3x400 V. F370 is also available in voltage version 3x230 V. Contact your NIBE dealer for more information.

Type		Stainless	Enamel
Output data according to EN 14 511			
Heating capacity (P <sub>H</sub> )/COP <sup>1</sup>	kW/-	2.18 / 3.93	
Heating capacity (P <sub>H</sub> )/COP <sup>2</sup>	kW/-	2.03 / 3.24	
Heating capacity (P <sub>H</sub> )/COP <sup>3</sup>	kW/-	1.88 / 2.74	
Rated heating output (P <sub>designh</sub> )	kW	3	
SCOP cold climate, 35°C / 55 °C		3.55 / 2.98	
SCOP average climate, 35 °C / 55 °C		3.35 / 2.83	
Additional power			
Max power, immersion heater (factory setting)	kW	10.3 (5.6)	10.3 (5.6)
Energy rating, average climate			
The product's efficiency class room heating, average climate 35 / 55 °C <sup>4</sup>		A+ / A+	
The system's efficiency class room heating, average climate 35 / 55 °C <sup>5</sup>		A+ / A+	
Declared tap profile/efficiency class hot water heating <sup>6</sup>		L / A	L / A
Electrical data			
Rated voltage	V	400 V 3N – 50Hz	
Enclosure class		IP 21	
Equipment Compliant with IEC 61000-3-12			
For Connection Design Purposes, Compliant with IEC 61000-3-3 technical requirements			
Refrigerant circuit			
Type of refrigerant		R290	
Volume	kg	0.4	
Heating medium circuit			
Opening pressure, safety valve	MPa/bar	0.25 / 2.5	
Max temperature, supply line (factory setting)	°C	70 (60)	
Ventilation			
Min. air flow at exhaust air temperature at least 20°C	l/s	28	
Min. air flow at exhaust air temperature below 20°C	l/s	31	
Noise			
Sound effect level according to EN 12 102 (L <sub>W(A)</sub> ) <sup>7</sup>	dB(A)	46.5-48.0	
Sound pressure level in the installation room (L <sub>P(A)</sub> ) <sup>8</sup>	dB(A)	42.5-44.0	
Water heater and heating section			
Volume heating section	litre	70	
Volume, hot water heater	litre	170	
Max pressure in hot water heater	MPa/bar	1.0 / 10.0	
Capacity hot water heating <sup>9</sup>			
Tap volume 40°C according to EN 255-3(V <sub>max.</sub> )	litre	248	
Tap volume 40°C according to EN 16 147(V <sub>max.</sub> )	litre	217	
Miscellaneous			
Required ceiling height	mm	2,170	
Weight	kg	195	205
Part No.		066 056	066 057

<sup>1</sup> A20(12)W35, exhaust air flow 56 l/s (200 m³/h)

<sup>2</sup> A20(12)W45, exhaust air flow 42 l/s (150 m³/h)

<sup>3</sup> A20(12)W55, exhaust air flow 31 l/s (110 m³/h)

<sup>4</sup> Scale for the product's efficiency class room heating: A+++ to D.

<sup>5</sup> Scale for the system's efficiency class room heating: A+++ to G. Reported efficiency for the system takes the product's temperature regulator into account.

<sup>6</sup> Scale for efficiency class hot water: A+ to F.

<sup>7</sup> The value varies with the selected fan curve. For more detailed sound data, including sound to channels, visit nibe.eu.

<sup>8</sup> The value can vary with the room's damping capacity. These values apply at a damping of 4 dB.

<sup>9</sup> A20(12) exhaust air flow 42 l/s (150 m³/h). Comfort mode normal

## Accessories

Detailed information about the accessories and complete accessories list available at [nibe.eu](http://nibe.eu).

Not all accessories are available on all markets.

### Docking kit DEH

There are separate docking kits available for connecting other heat sources to the heat pump.

### Docking kit Solar 41

Solar 41 means that F370 together with e.g. NIBE UKVS 230 can be connected to thermal solar heating.

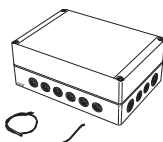

### Extra shunt group ECS

This accessory is used when F370 is installed in houses with two or more different heating systems that require different supply temperatures.

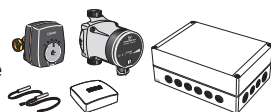

### Communications module SMS 40

When there is no internet connection, you can use the accessory SMS 40 to control F370 via SMS.



### Room unit RMU 40

The room unit is an accessory with a built-in room sensor, which allows the control and monitoring of F370 to be carried out in a different part of your home to where it is located.



### Solar package NIBE PV

NIBE PV is a modular system comprising solar panels, assembly parts and inverters, which is used to produce your own electricity.



### Accessory board AXC 20

Accessory board for hot water circulation, damper for frost protection and/or external heating medium pump.

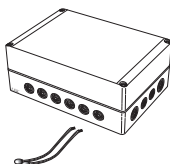

### Supply air module SAM

SAM is a supply air module specially developed for houses with supply and exhaust air systems.

#### SAM 42

(approx. 28–70 l/s)

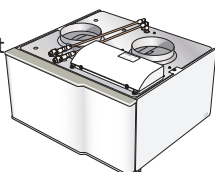

## Water heater/Accumulator tank

For information regarding suitable water heaters, see [nibe.eu](http://nibe.eu).

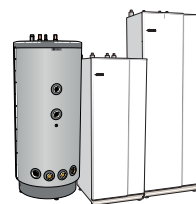

## Top cabinet TOC 30

Top cabinet, which conceals any pipes/ventilation ducts.

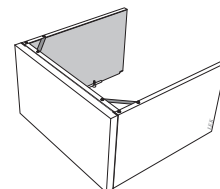



# Sustainable energy solutions since 1952

---

NIBE has been manufacturing energy-efficient and sustainable climate solutions for your home for 70 years. It all began in Markaryd, in the southern Swedish province of Småland, and we recognise our Nordic heritage by utilising the power of nature. We combine renewable energy with smart technology to offer efficient solutions, allowing us to work together to create a more sustainable future.

Regardless of whether it is a chilly winter's day or a warm afternoon in the summer sun, we need a balanced indoor climate that allows us to enjoy a comfortable life, whatever the weather. Our extensive range of products supply your home with cooling, heating, ventilation and hot water, making it possible for you to create a pleasant indoor climate with little impact on the environment.

NIBE Energy Systems  
Box 14, SE-285 21 Markaryd  
[nibe.eu](https://nibe.eu)



---

This product sheet is a publication from NIBE Energy Systems. All product illustrations, facts and data are based on current information at the time of the publication's approval. NIBE Energy Systems makes reservations for any factual or printing errors in this product sheet.